

| Series | LED | Junction Box | E26/Med. Base | Dimming | Exterior | Interior | Feed-Thru | Other Options |
|--------|-----|--------------|---------------|---------|----------|----------|-----------|---|
| 158 | ● | ● | ● | ● | ● | ● | ● | Bronze faceplate LED colors Sharp cutoff louver Faceplate colors |

Steplites

158 SERIES

Description

The 158 Series of Steplites is a low-profile, "brick size" site fixture with LED, fluorescent, and incandescent lamp options. It is suitable for a variety of interior or exterior applications. The rugged construction, engineering excellence, and quality make these fixtures ideal for specification in most public areas.

Features

Louvers in the 158 Series are more widely spaced than most fixtures of this type, allowing for significantly greater forward projected illumination. Exceptional durability is provided by the thick cast aluminum faceplate and the tempered glass diffuser. Louvered models offer even greater protection to the diffuser while controlling the distribution of light. Cole Steplites feature an optional cast aluminum junction box which may be easily field mounted to either the back or bottom of the housing to best suit installation conditions.

Applications

The 158 Series Steplites are suitable for concrete pour/block wall and stud wall mounting in indoor or outdoor installations. They are ideal in low walls and side mounting at stairs. LED modules will work well in extremely cold climates. They are ideal in low walls and step risers.

Custom

If your project demands a special fixture we would be pleased to discuss the production of modified standard fixtures or custom fixtures to suit your specific conditions. For more information on our custom capabilities, please contact your local Cole representative.



T158W-J — E26 medium base lamp



L158GW-B-J — Cast bronze faceplate



L158W-N-J — Stainless steel faceplate



L158W-SCL-BLK — Sharp cutoff louver



The junction box on Cole Steplites may be field mounted to the back or bottom of the fixture.

LED with standard or high output options, may be specified for this series.



C.W. Cole & Company, Inc.
2560 Rosemead Boulevard
South El Monte, CA 91733-1593

Tel. (626) 443-2473
Fax (626) 443-9253
info@colelighting.com
www.colelighting.com

Louver

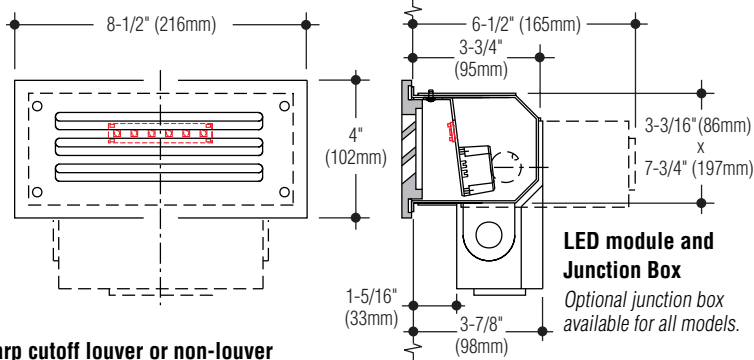

Sharp cutoff louver or non-louver

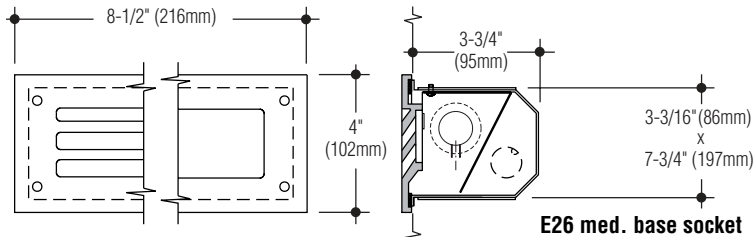

Stainless steel faceplate

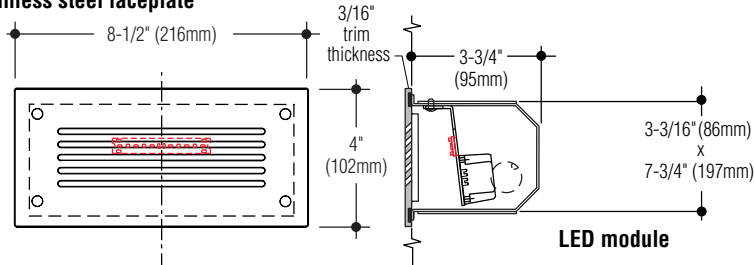

Steplites

158 SERIES

SPECIFICATIONS

Construction

- Fixture housing is constructed from die-formed 16 gauge electro-galvanized steel finished with a white polyester coating
- Faceplate is cast aluminum with metallic aluminum polyester coating, gasketed and retained by stainless steel screws
- Diffuser is frosted tempered glass, set in silicone sealant
- Optional junction box is cast aluminum with polyester coating
- All models are cETLus listed for wet locations in any wall construction.

Electrical

- Fixture is wired with high performance LED modules or one E26 medium base lamp socket
- Integral driver is standard universal voltage
- Housing provided with 1/2" conduit knockout on each side suitable for 4 wire thru-wiring, 2 in and 2 out
- Optional junction box allows 8 wire thru-wiring, 4 in and 4 out. Provided with two 1/2" tapped conduit entrances in the bottom and one 1/2" tapped conduit entrance in each side.

Mounting

Housing has flange with holes for mounting.

How to Specify

1. Select catalog number with desired features.
2. Add suffixes for options required to meet job conditions

Catalog Numbers

Lamp

LED 1.5W, (126 lm @ 3000°K)
 LED 3.4W, (331 lm @ 3000°K)
 LED 6.8W, (662 lm @ 3000°K)
 One E26 medium base lamp

Faceplate

Louver

L158W
L158W-HO
L158W-HO-2
T158W

Non-Louver

L158GW
L158GW-HO
L158GW-HO-2
T158GW

Lumens shown are source.

Photometric data available for Steplites can be downloaded at: <https://www.colelighting.com/photometrics>

Options

Junction box: Bottom or back mounted junction box for feed-thru. Add suffix **-J**.

Stainless Steel faceplate: 3/16" thick narrow louvered or glass trim non-louver faceplate. Add suffix **-N**.

Sharp cutoff louver: Below horizontal illumination, cast aluminum. Add suffix **-SCL**.

Cast Bronze faceplate: Satin finish, clear coated. Add suffix **-B**.

Stainless Steel housing: 16 gauge stainless steel recessed housing. Add suffix **-SS**.

Dimming: Universal voltage 0-10V driver. Add suffix **-DIM**.

Emergency battery (4 Watt): Provides up to 90 minutes operation. Add suffix **-EM**.

Alternate faceplate color: Black, white or custom color. Add suffix **-BLK**, **-WHT**, or **-CC**.

Opal glass diffuser: Tempered. Add suffix **-OPL**.

Spread Lens: Ribbed tempered glass. Add suffix **-ST**.

Tamperproof screws: Socket head faceplate screws. Add suffix **-TP**.

LED colors:

4000°K (146 lm), **-HO** (384 lm), **-HO-2** (768 lm). Add suffix **-4K**.

Amber* (FWC compliant, 590 nm). Add suffix **-AMB**.

Blue* Add suffix **-BLU**.

* Not available in HO-2.

How to Specify

1. Select catalog number with desired features.
2. Add suffixes for options required to meet job conditions



C.W. Cole & Company, Inc.
 2560 Rosemead Boulevard
 South El Monte, CA 91733-1593

Tel. (626) 443-2473
 Fax (626) 443-9253
info@colelighting.com
www.colelighting.com